

# Dynamic Interactive

## Urbanscapes

Li Shu Lin (1505082)  
Chiah Chong Way (1608062)  
MM1608-1

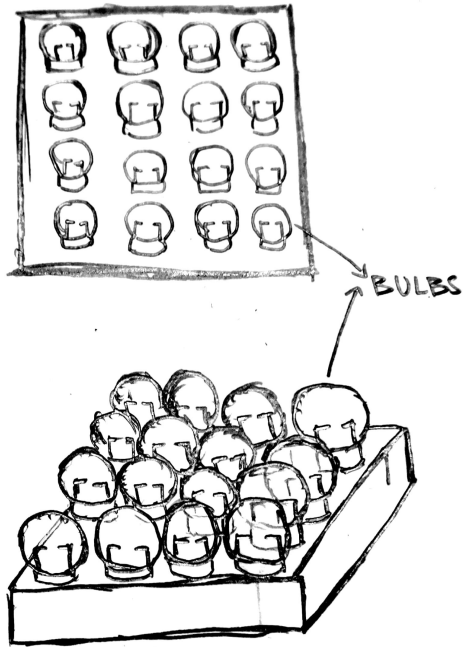

This is a interactive box with bulbs and musical in it.

The box can be control by using hand touch.

Whenever the bulbs been touched, it will give feedback to the user by lighting up the bulbs and also play the tone/beat that setup on the bulb.

Each bulb will have different kind of tone/beat when get touch by user.

---

## 1- Musical Bulb Box

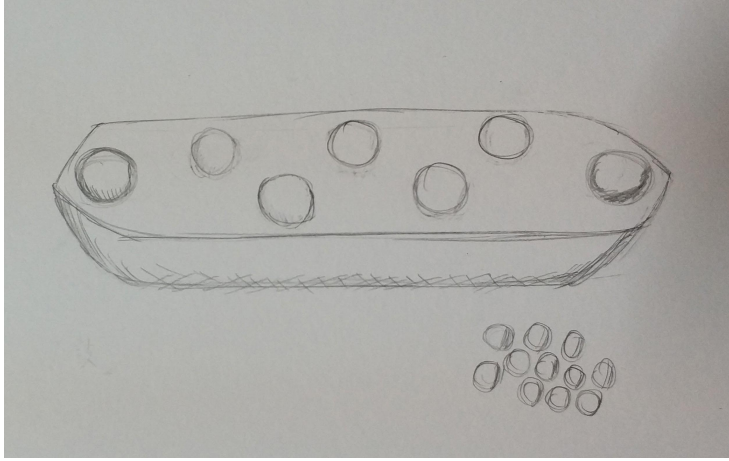

---

This is a musical instrument, user control the sounds switch by putting ZHUZI, control speed by the number of the ZHUZI

---

## 2- Congkakist

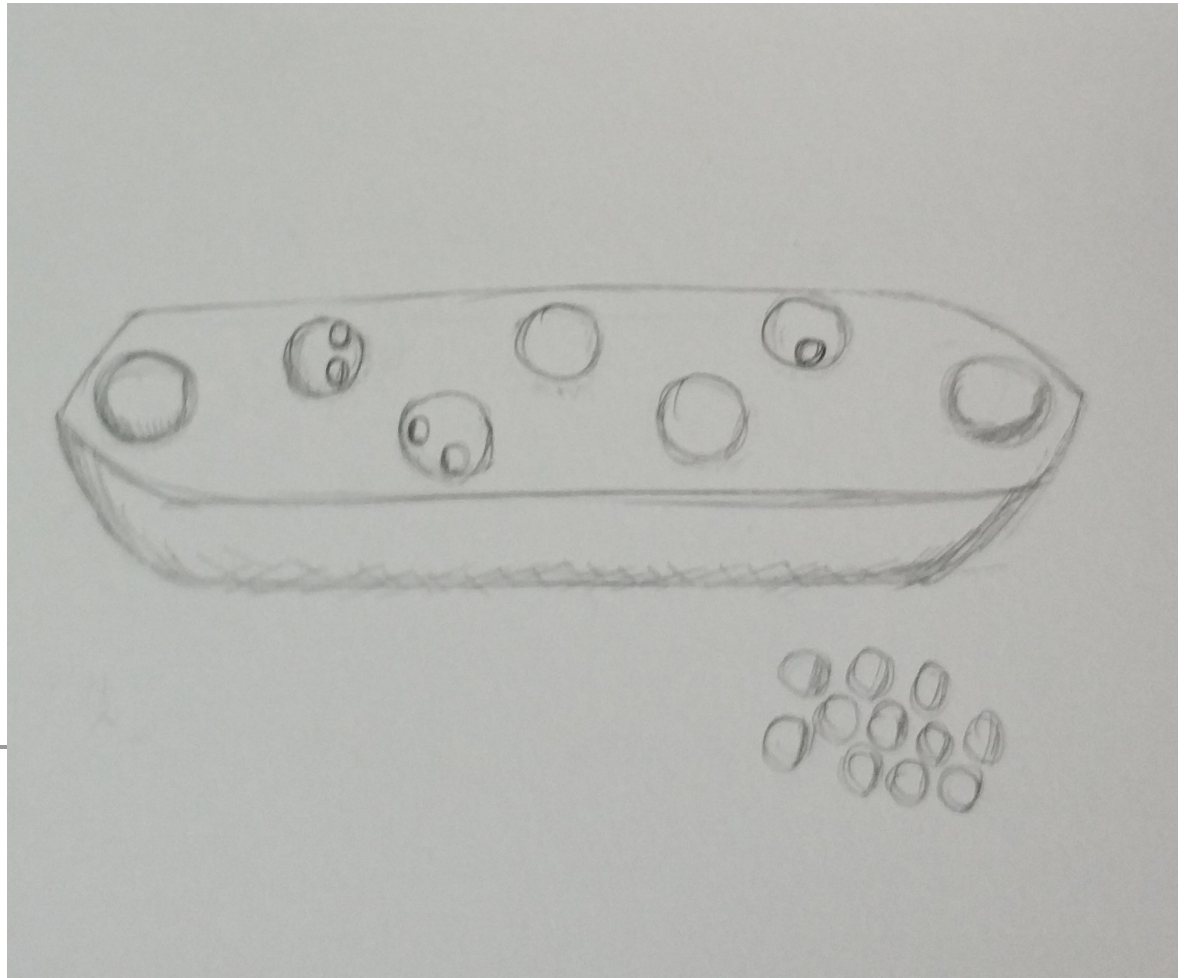

---

## 2- Congkakist

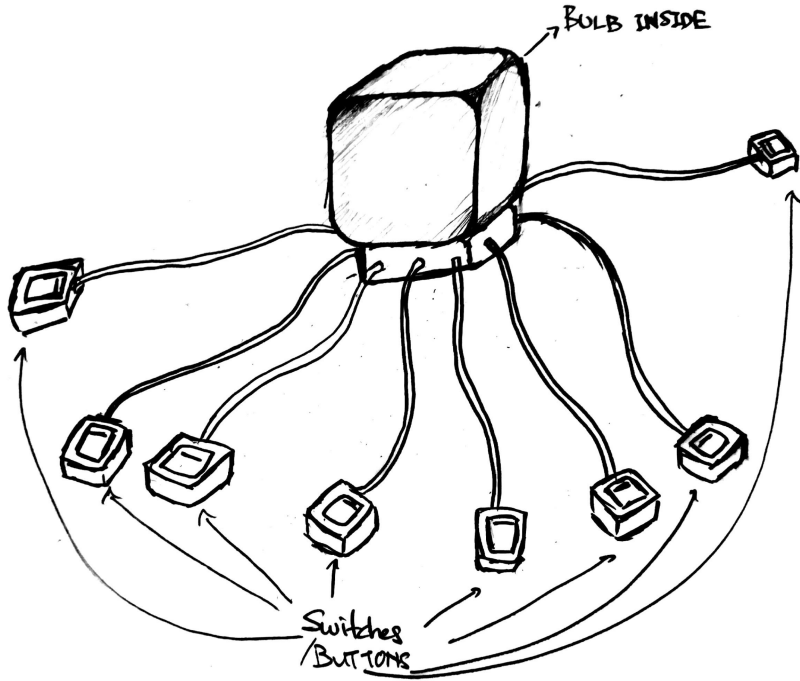

---

This setup is a musical interactive installation by using different color of bulb and switches.

Every different switches have their own setups of colors of bulbs and also tone/beat.

The user will need to press the switches to interact with the bulb.

The bulb will lights up and blink with the speed of the tone/beat when get pressed.

---

### 3- Bulb & Switches

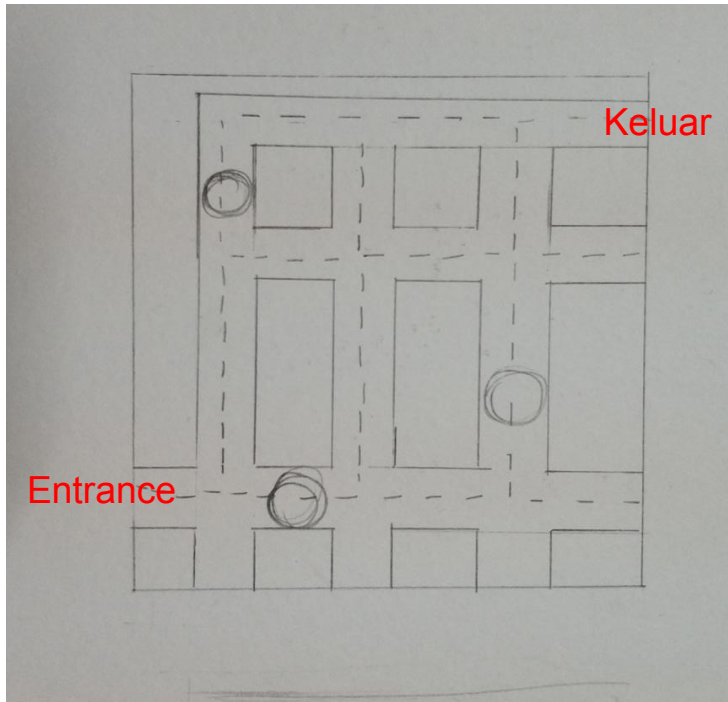

This project is a maze. There is a light from entrance, user control the mirror to reflect the light and at the end finish the Journey.

---

## 4- Maze to the Journey

---

## 4- Maze to the Journey

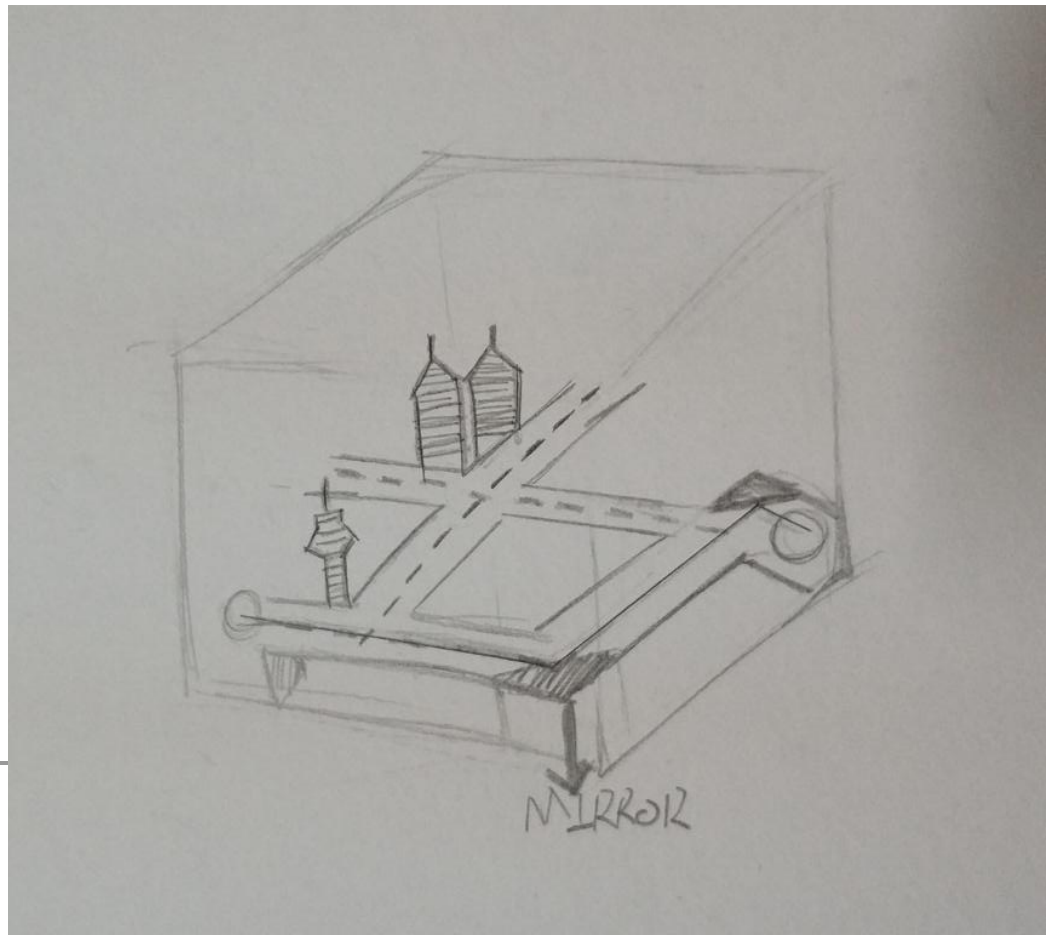

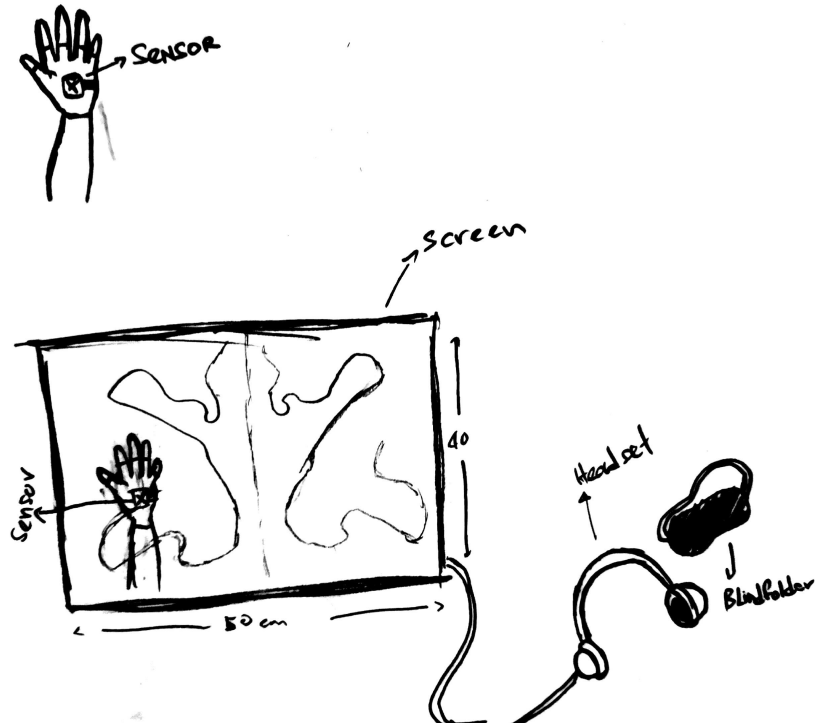

---

This installation is an interactive painting with feeling the sound of the nature.

User will have to wear a sensor on the palm and blindfolded. By hearing through the headset, user can use their hand to move around and hear different kinds of sound.

With the sensor on the palm, paint will be drawn by the movement of the sensor.

---

## 5- Hear, Feel and Paint